

**Generator set**

**Sound-proof type**

**WPS350S-AU**

# **SPECIFICATIONS**

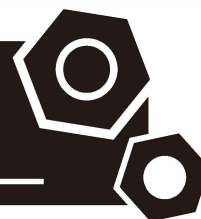

## 1 Standards & Conditions

### Design Standards

The designs and the productions are in conformity with:

- Conformance Européenne (CE)
- ISO8528-5:2005
- AS 3000-2018
- AS 3010-2017

### Environmental Operating Conditions

- Installation place: Outdoors or indoors (well ventilated).
- Ambient temperature: -25°C to 50°C. The coolant heater is needed when the temperature is below 5°C
- Humidity: Less than 90%.
- Altitude: Below one thousand (1000) meters above sea level.

### Factory Inspection

- Inspection items.
- Protection devices working test.
- Starting ability in normal temperature.
- 50% rated power load moment capability.
- Voltage deviation and speed variation: 0%, 25%, 50%, 75%, 100%, 110% Load.

### Painting Process

- Painting process specifications and colors are based on the manufacturer's standard.
- The customer could also choose the color which the manufacturer offers.

## 2 General Features

- Perkins engine 2206C-E13TAG2
- Close coupled to Leroy Somer alternator LSA46.3L11
- Microprocessor controller ComAp Intelilite4-AMF9
- ABB main circuit breaker: 500A
- Rotate speed governor: Electronic
- Excitation System: Self Excited
- A.V.R.Model: R250
- Key switch
- Emergency stop switch
- ATS (automatic transfer switch) receptacle

- Remote run connector
- 2x12V/120AH sealed for life maintenance free battery
- Lockable battery isolator switch
- Powder coated canopy
- 50°C radiator
- Oil pump on the engine
- Non-returning valve for fuel inlet hose of the engine
- Steel base frame with forkslots
- Vibration isolators between the engine/alternator and base frame
- Dry type air filter
- Base fuel tank for 20hours running
- Drain points for fuel tank
- Breather valve for fuel tank
- Operation Manual / Specifications

## 3 Equipment Specification

### General technical data

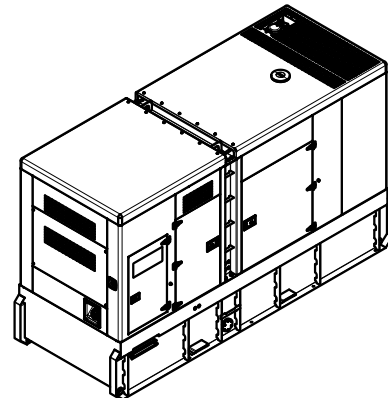

Model.....	WPS350S-AU
Structure type .....	R
Tank capacity.....	1640L
Dry weight.....	4565kg
Noise level @7m .....	74.4dBA
Dimensions L×W×H.....	4242x1550x2476mm
Standby Power .....	385kVA/308kW
Prime Power .....	350kVA/280kW
Voltage/Current.....	415V/417A

Genset Fuel Consumption					
Frequency/Load	25%	50%	75%	100%	110%
50Hz (L/h)	N/A	41	59	76	87

## Diesel engine

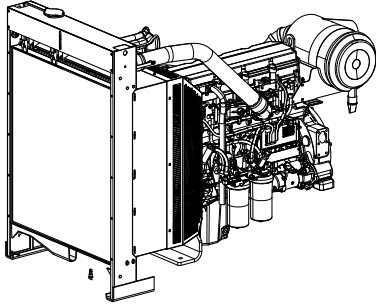

Engine Manufacturer/Brand.....	Perkins
Engine Model.....	2206C-E13TAG2
Dimensions L×W×H.....	2410×1120×1725mm
Dry Weight (approx.) .....	1478Kg
Number of Cylinders.....	6
Bore.....	130mm
Stroke .....	157mm
Displacement.....	12.5L
Compression Ratio.....	16.3
Type of injection.....	Direct injection
Intake System.....	Turbocharged, air-to-air charge cooled
Intake Resistance.....	N/A
Cooling System .....	Water cooled
Fan .....	Pusher
Battery Voltage.....	24V
Type of Fuel....	BSEN590 or ASTM D975 Class 1D and 2D.
Type of Oil .....	15W40 to API CI4.
Oil Capacity .....	40L
Type of Coolant .....	Glycol mixture
Coolant Capacity .....	51.4L
Heat Rejected To Exhaust System	251.8kW(14101BTU/min)
Heat Rejected To Water&Oil.....	118.4kW(6630BTU/min)
Back Pressure.....	N/A
Standby Power .....	320kW
Prime Power.....	280kW
Fuel Consumption(100%load).....	75L/h

## Alternator

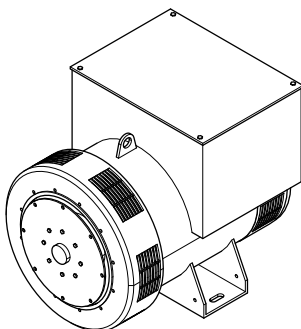

Alternator Manufacturer/Brand .....	Leroy Somer
Alternator Model .....	LSA46.3L11
Exciter.....	Brushless
Cooling Fan .....	Cast alloy aluminum
Windings.....	100% copper
Insulation Class .....	H
Winding Pitch.....	2/3
Terminals .....	12
Drip Proof .....	IP23
Altitude.....	≤1000m
Overspeed .....	2250rpm
Air Flow.....	0.9m³/s(50Hz), 1.1m³/s(60Hz)
Voltage Regulation .....	±0.5%
Total harmonic TGH / THCat no load	< 1,5 % - on load < 2 %
Telephone Interference.....	THF<2%;TIF<50

## IntelliLite4-AMF9 Control System

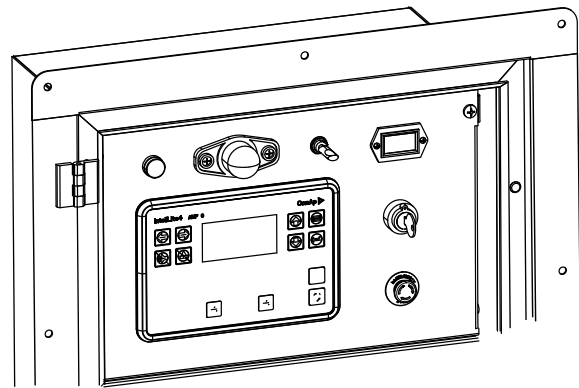

IntelliLite4-AMF9 is Single Gen-set controller for stand-by and prime-power applications and all-in-one intuitive & powerful PC tool for configuration/monitoring/control, locally or remotely and easy to install, configure and use

### Standard Control Function

- Stand-by and prime-power application in one unit
- Dual Mutual Standby application support
- Remote display
- User setpoints and protections
- User Access Management
- Cyber security improvement
- Alternative configurations
- Multi-purpose schedulers

## 4 Overall Dimensions

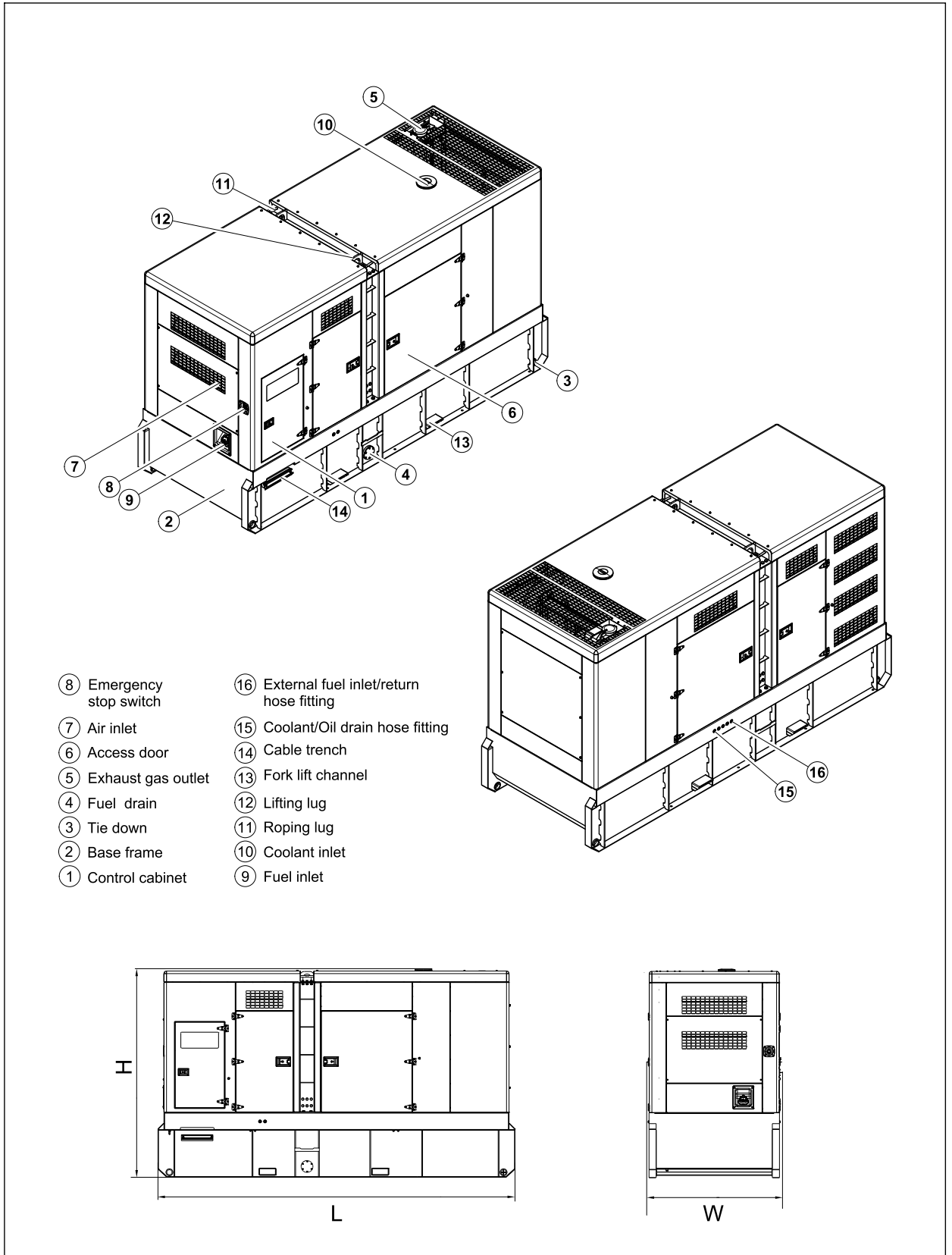

## 5 Control System

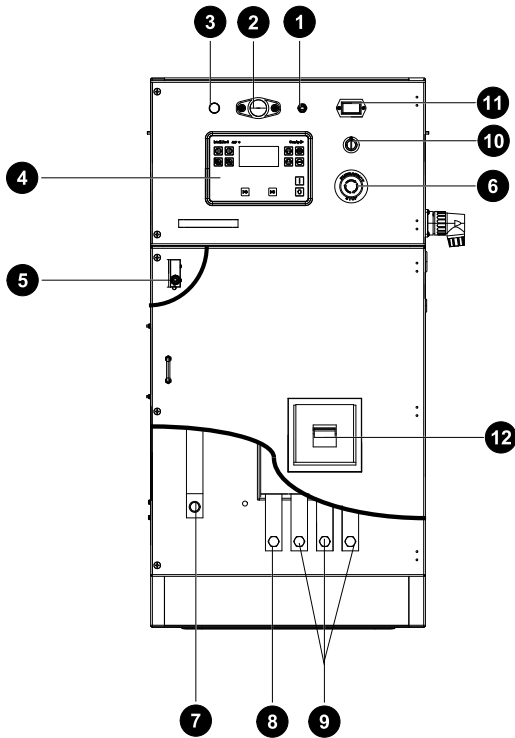

Control & field wiring cabinet

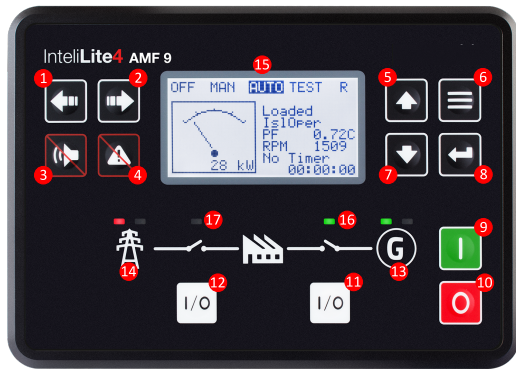

Control module

Ref.	Description
1	Control cabinet lamp switch
2	Control cabinet lamp
3	Charge indicator
4	Control module
5	Limit switch
6	Emergency stop button
7	Ground wire terminal
8	Neutral wire terminal
9	Live wire terminals
10	Key switch
11	Time counter
12	Main circuit breaker

Ref.	Description
1	LEFT button.
2	RIGHT button
3	HORN RESET button
4	FAULT RESET button
5	UP button
6	PAGE button
7	DOWN button
8	ENTER button
9	START button
10	STOP button
11	GCB button
12	MCB button
13	GENERATOR status indicator
14	MAINS status indicator
15	Graphic B/W display, 132 × 64 px.
16	GCB Status
17	MCB Status

1000034391-B3-E
-----------------

04.2023
---------

<http://www.powerlinkworld.com>

*Specification may change without prior notice. For more info.,  
contact Power Link or your local distributors please.*